



March 25, 2021

To learn more about Frost Creek real estate, please contact
Kakie Holland Frost Creek's Director of Sales.

KAKIE HOLLAND
970.455.3072 - Office | 970.319.5585 - Mobile
kholland@frostcreek.com

FROST CREEK
MEMBER CABINS AND YURTS

1 Bluebell	7 Shooting Star
2 Buttercup	8 Yarrow
3 Columbine	9 Gray Rock
4 Larkspur	10 Cottonwood (Yurt)
5 Primrose	11 Aspen (Yurt)
6 Sage	



Pricing and availability is subject to change without notice. Homesite acreage is approximate.

HUNTER'S VIEW
DETAILS ON REVERSE SIDE



97
4.99
\$600K

LEGEND

■ AVAILABLE	● UNDER CONTRACT
■ SOLD	● FUTURE RELEASE
■ UNDER CONSTRUCTION	

To Sylvan Lake
8.6 Miles

To Eagle Main St.
7.9 Miles

SITE PLAN

PHASES 1 & 2 : ARTIST RENDERING

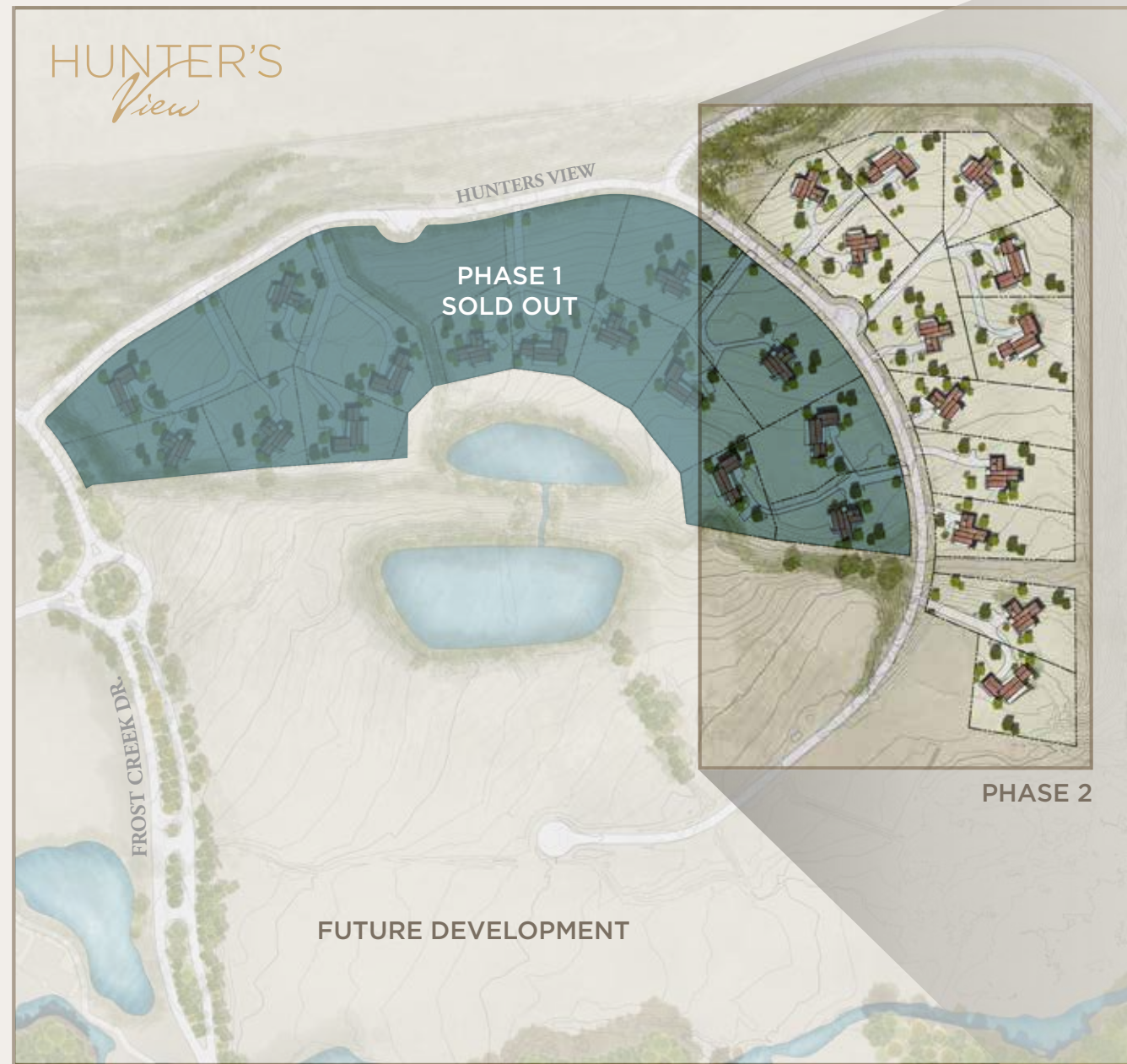

PHASE 2 RESIDENCES

Hunter's View Phase 2 consists of 12 properties in all:

4 Borah | 3 Scout | 5 Roosevelt

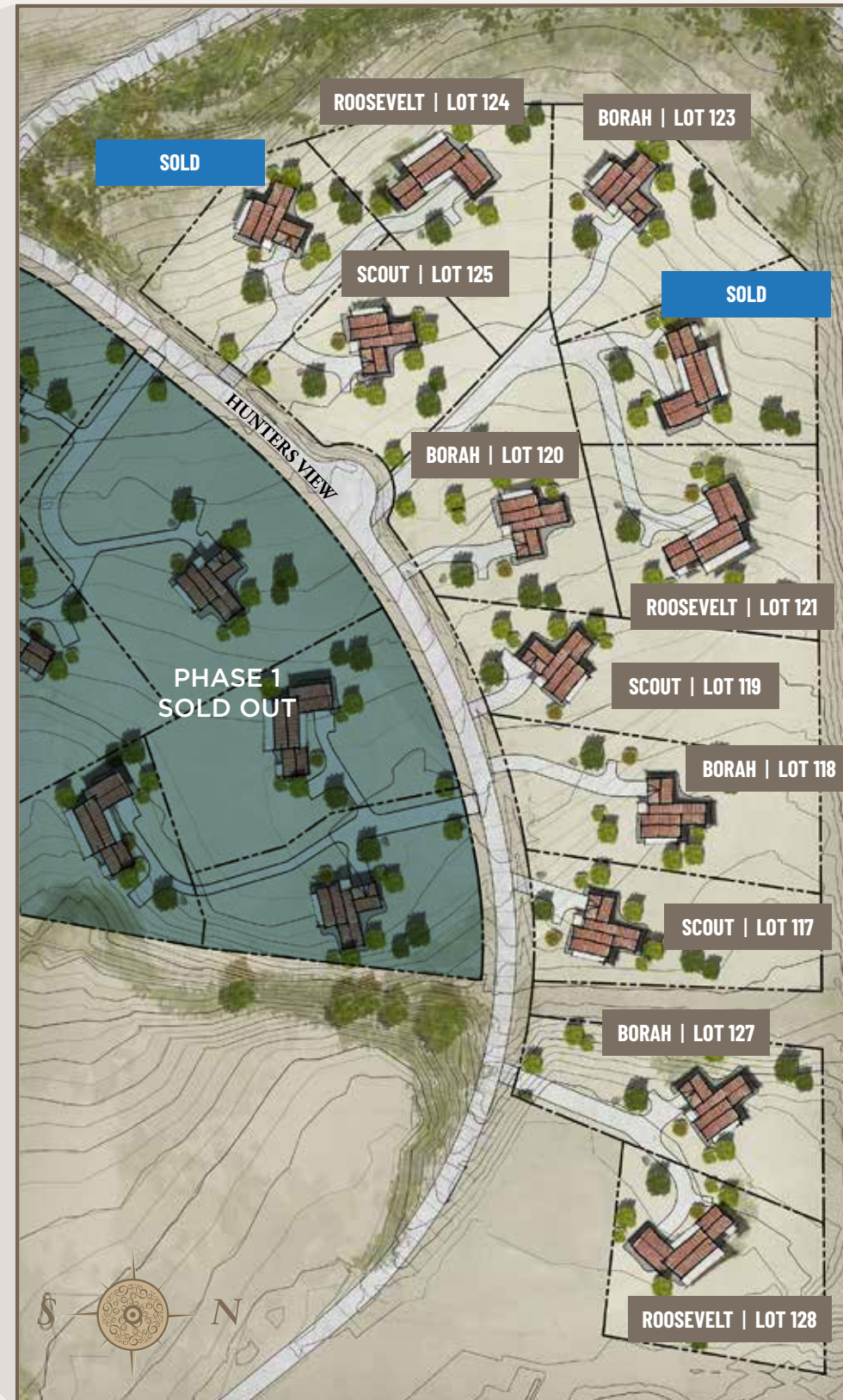

PHASE 2 DETAIL

INTRODUCING FROST CREEK'S NEWEST
REAL ESTATE OFFERING.

HUNTER'S *View*



SCOUT 2,300 SF / 3 Bed / 2.5 Bath



BORAH 2,680 SF / 4 Bed / 3.5 Bath



ROOSEVELT 2,875 SF / 4 Bed / 3.5 Bath



FOR MORE INFORMATION CONTACT:

Katherine "Kakie" Holland
DIRECTOR OF SALES, GRI, CNE
970.455.3072 (O) / 970.319.5585 (M)
kholland@frostcreek.com

1094 Frost Creek Dr., Eagle, CO 81631

Mailing: PO Box 659, Eagle,
Colorado 81631

www.frostcreek.com/huntersview