



November 12, 2021

To learn more about Frost Creek real estate, please contact
Kakie Holland Frost Creek's Director of Sales.

KAKIE HOLLAND
970.455.3072 - Office | 970.319.5585 - Mobile
kholland@frostcreek.com

FROST CREEK
MEMBER CABINS AND YURTS

1 Bluebell	7 Shooting Star
2 Buttercup	8 Yarrow
3 Columbine	9 Gray Rock
4 Larkspur	10 Cottonwood (Yurt)
5 Primrose	11 Aspen (Yurt)
6 Sage	



Pricing and availability is subject to change without notice. Homesite acreage is approximate.

LEGEND

		AVAILABLE		UNDER CONTRACT
		SOLD		FUTURE RELEASE
		UNDER CONSTRUCTION		

HUNTER'S VIEW
DETAILS ON REVERSE SIDE

HUNTER'S
View

GATE-HOUSE

MAIN ENTRANCE

To Eagle Main St.
7.9 Miles

To Sylvan Lake
8.6 Miles

97
4.99
\$750K

59
4.29
\$895K
RESALE

54
5,437 SF
\$739K
RESALE

31
4.01
\$860K
RESALE

34
4.54
\$950K
RESALE

17
3.99
\$825K

SITE PLAN

ARTIST RENDERING

PHASE 1
SOLD OUT

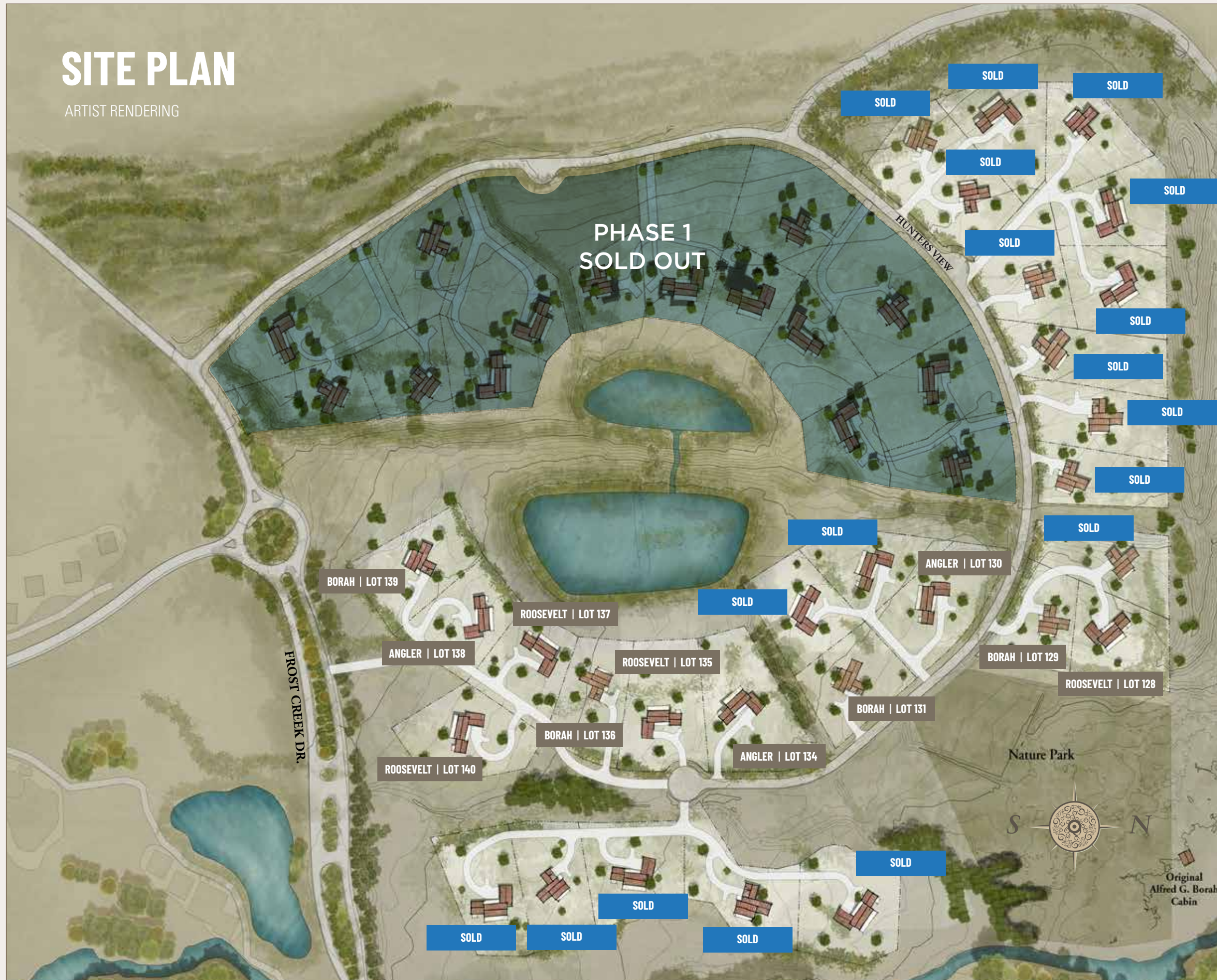

INTRODUCING FROST CREEK'S NEWEST
REAL ESTATE OFFERING.

HUNTER'S *View*



BORAH 2,680 SF / 4 Bed / 3.5 Bath



ROOSEVELT 2,875 SF / 4 Bed / 3.5 Bath



ANGLER 2,875 SF / 4 Bed / 4.5 Bath



FOR MORE INFORMATION CONTACT:

Katherine "Kakie" Holland
DIRECTOR OF SALES, GRI, CNE
970.455.3072 (O) / 970.319.5585 (M)
kholland@frostcreek.com

1094 Frost Creek Dr., Eagle, CO 81631

Mailing: PO Box 659, Eagle,
Colorado 81631

www.frostcreek.com/huntersview