



April 8, 2024

To learn more about Frost Creek real estate, please contact the sales office at 970.455.3072.

KAKIE HOLLAND
 Director of Sales, GRI, CNE
 970.319.5585 - Mobile
 kholland@frostcreek.com

LYNNE SANDOVAL
 Sales Executive
 303.551.2689 - Mobile
 lsandoval@frostcreek.com

FROST CREEK

MEMBER CABINS AND YURTS

1 Bluebells	8 Yarrow
2 Buttercup	9 Gray Rock
3 Columbine	10 Brook
4 Larkspur	11 Brown
5 Primrose	12 Cutthroat
6 Sage	13 Aspen (Yurt)
7 Shooting Star	14 Cottonwood (Yurt)



Pricing and availability is subject to change without notice. Homesite acreage is approximate.

State of Colorado

SITE PLAN

ARTIST RENDERING

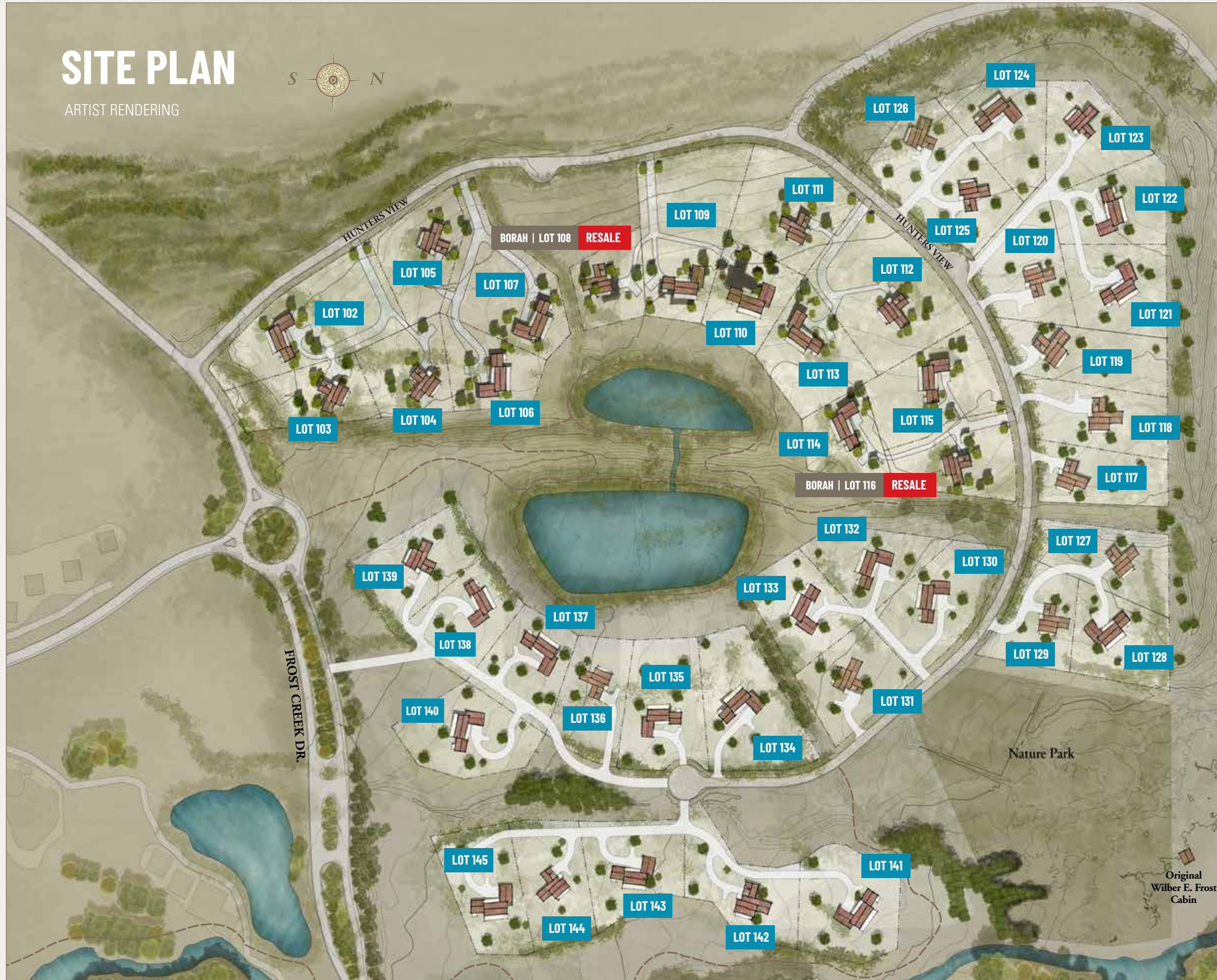

HUNTER'S *View*

FEATURED HOMES



BORAH 2,886 SF / 4 Bed / 3.5 Bath
Lot 108 / 216 Hunters View Ln. \$2,600,000



BORAH 2,886 SF / 4 Bed / 3.5 Bath
Lot 116 / 448 Hunters View Ln. \$2,375,000



TO LEARN MORE ABOUT HUNTER'S VIEW, PLEASE CONTACT THE SALES OFFICE AT 970.455.3072.

KATHERINE "KAKIE" HOLLAND
Director of Sales, GRI, CNE
970.319.5585 - Mobile
kholland@frostcreek.com

LYNNE SANDOVAL
Sales Executive
303.551.2689 - Mobile
lsandoval@frostcreek.com

1094 Frost Creek Dr., Eagle, CO 81631

Mailing: PO Box 659, Eagle, Colorado 81631

www.frostcreek.com/huntersview