



April 8, 2024

To learn more about Frost Creek real estate, please contact the sales office at 970.455.3072.

**KAKIE HOLLAND**  
 Director of Sales, GRI, CNE  
 970.319.5585 - Mobile  
 kholland@frostcreek.com

**LYNNE SANDOVAL**  
 Sales Executive  
 303.551.2689 - Mobile  
 lsandoval@frostcreek.com

### FROST CREEK

#### MEMBER CABINS AND YURTS

1 Bluebells	8 Yarrow
2 Buttercup	9 Gray Rock
3 Columbine	10 Brook
4 Larkspur	11 Brown
5 Primrose	12 Cutthroat
6 Sage	13 Aspen (Yurt)
7 Shooting Star	14 Cottonwood (Yurt)



Pricing and availability is subject to change without notice. Homesite acreage is approximate.

HUNTER'S View

GATE-HOUSE

MEMBER CABINS

NATURE PARK

Original Wilber E. Frost Cabin

MAIN ENTRANCE

# SITE PLAN

ARTIST RENDERING

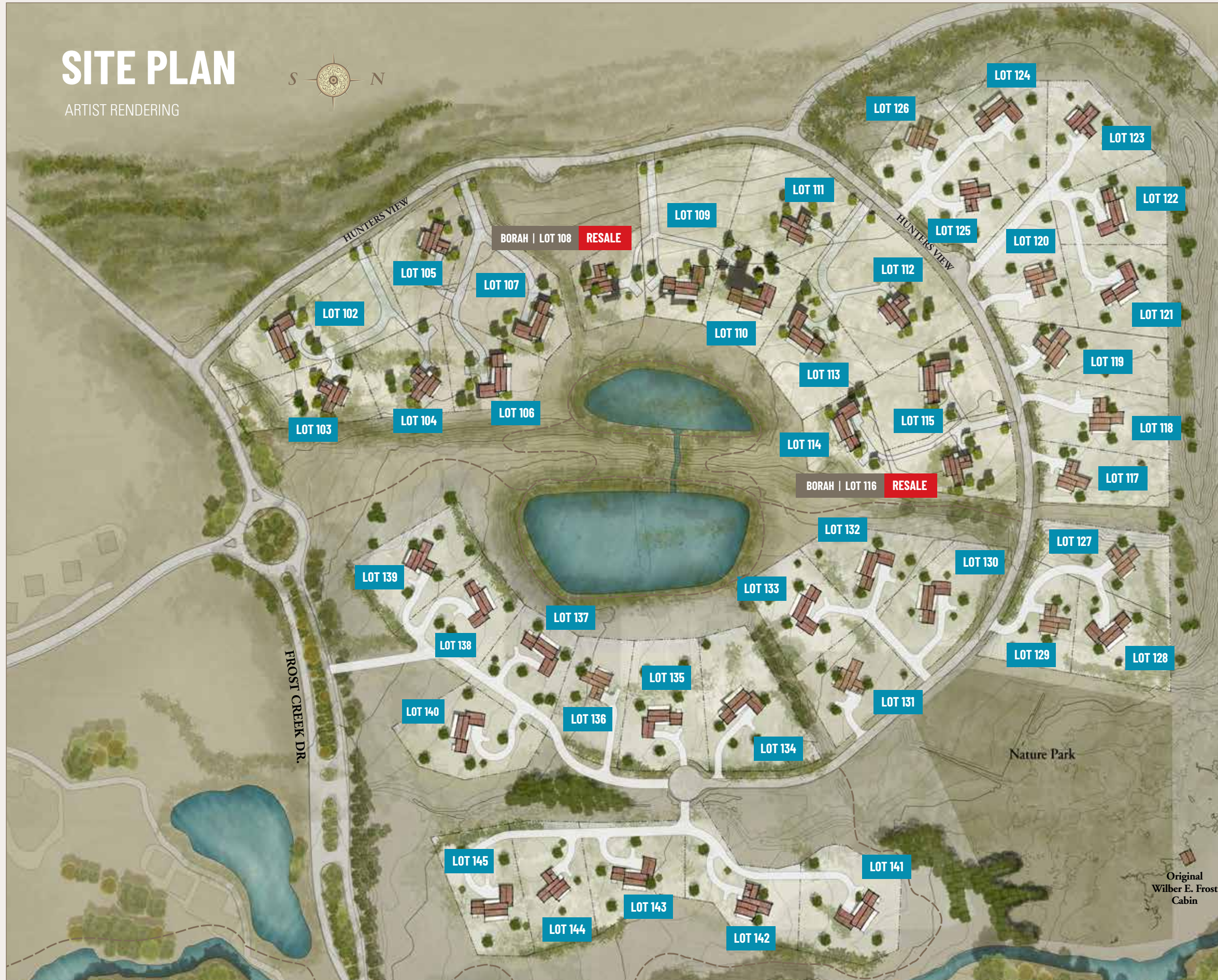

# HUNTER'S *View*

## FEATURED HOMES



**BORAH** 2,886 SF / 4 Bed / 3.5 Bath  
Lot 108 / 216 Hunters View Ln. \$2,600,000



**BORAH** 2,886 SF / 4 Bed / 3.5 Bath  
Lot 116 / 448 Hunters View Ln. \$2,375,000



TO LEARN MORE ABOUT HUNTER'S VIEW, PLEASE CONTACT THE SALES OFFICE AT 970.455.3072.

**KATHERINE "KAKIE" HOLLAND**  
Director of Sales, GRI, CNE  
970.319.5585 - Mobile  
kholland@frostcreek.com

**LYNNE SANDOVAL**  
Sales Executive  
303.551.2689 - Mobile  
lsandoval@frostcreek.com

1094 Frost Creek Dr., Eagle, CO 81631

Mailing: PO Box 659, Eagle, Colorado 81631

[www.frostcreek.com/huntersview](http://www.frostcreek.com/huntersview)